

PEOPLE
IN THE
NEWS

Michael J. Bowl, 1605 Laura St., Anaheim, has been appointed sales manager for the Precision Products Division of Western Gear Corp., Lynwood. He joined Western Gear in 1959 as a sales engineer and became a district sales manager in 1965.

Douglas W. Lohman of Fullerton has been appointed general manager of the Weldwood Structures Division of U.S. Plywood-Champion Papers Inc., with division headquarters in Santa Fe Springs.

Richard Thrasher of Ventura has been named merchandising manager in Southern California for Seagram Distillers Co.

Bernard Paul Pedersen, 5255 The Toledo, Long Beach, has been appointed agent for the Downtown Long Beach district agency of the Prudential Insurance Co. He served with the U.S. Navy from 1948 to 1967.

J. A. Crawford, 9904 Newcomb Ave., Whittier, has been named sales representative for Thombert Inc., Newton, Iowa, distributor and fabricator of industrial plastics. His territory covers California and Arizona.

Donald C. Jacks has been promoted to claims manager for the Continental Insurance Companies in Long Beach. Jack, who has been with Continental since 1963, was formerly a supervising examiner on the staff in San Francisco.

Jerold D. Bohannon, 5881 Padua Drive, Huntington Beach, has been appointed a commercial account executive for the Allstate Insurance Companies for the Long Beach area. He will be located at the Long Beach office at 6200 E. Spring St.

K. L. Glomski, who had been Dallas zone manager for R. F. Goodrich Tire Co., five years, has been named sales manager of dealer sales for the Los Angeles Long Beach zone.

Stuart Meyers, 3301 Rossmore Way, Los Alamitos, has been named executive director for the Urbanus Square office of William L. Pereira & Associates Corona Del Mar.

Two new directors have been added to the board of the Santa Fe Drilling Co. They are Robert N. Pomero, president of J. H. Pomero & Co., and Delo H. Caspary of the Caspary-Wendell Work Boats. Both were acquired by Santa Fe Drilling last year. Four new vice presidents assigned to the contract drilling division have been named. Neal V. Parry is to be assistant general operations manager. John P. Johnson is manager of North American drilling. Robert E. Steele is division general personnel manager and Gordon M. Anderson is divisional contract administration manager. The company also announced that L. Sandy Jr., a petroleum engineer has become president of its subsidiary, Santa Fe Marine Inc.

Mrs. Ronald L. Budman, assistant accounting manager at Buena Cardoza Greeting Cards in Abacim, has been elected a director of the Orange County Chapter of the National Association of Accountants. She resides in Fountain Valley.

Following the appointment of Bernard Bailey to the post of vice president sales, several additional appointments have been made at Nutrilite Products Inc., Buena Park. All activity in the sales division has been aligned under the supervision of Dr. C. S. Rehnsborg of Laguna Beach. Clifford H. Clauss has been named general sales manager. Richard Rhodes has been named midwest sales manager. Dan Rogers of Newport Beach is sales manager and his duties will include development of self improvement courses. Named merchandising and sales promotion manager is Penny Sterling of Buena Park.

Mrs. Richard Johnson of Anaheim has been named manager of communications. Mr. and Mrs. Lloyd Uker attended a Humble Oil Co. Conference in Palm Springs. They live at 6741 El Roble Ave., Long Beach. Charles A. Zubieta,



BORN IN CALIFORNIA... The GT/CS



By ART STEPHAN
Auto Editor

A new model Ford Mustang designed especially for California has made its public debut at Ford dealers.

L. S. Grey, Los Angeles district sales manager for Ford Division, said the new California Special, designated the Mustang ST-CS, will be recognized easily by its design features that include a racing spoiler, competition-type hood latches and scoops on the side.

The Ford assembly plant in San Jose will build the car. It will be sold only in the two California sales districts.

"THE CALIFORNIA DISTRICTS account for about 30 per cent of the Mustang sales," Grey said, "so we felt it appropriate to have a model for this area that was inspired by our market."

The 1968 Shelby Cobra GT's influence on the new Mustang is apparent in the horizontal taillights and rectangular fog lamps.

Besides the racing spoiler, other distinguishing design highlights of the rear include a fiberglass deck lid with a dual stripe around the edge. The front end features a black out grille without ornamentation and the push-and-turn hood locks.

IDENTIFYING CHARACTERISTICS on the side include the scoops to the rear of the doors and California Special written in script on the back fenders. Bold stripe letters GT-CS decorate the scoops. A wide body stripe begins at the scoops and extends forward to the edge of the front fender.

Dealers will sell the California Special with any of the engine-transmission combinations in the regular Mustang line. Most regular Mustang options also will be available.

A. O. Smith in Ionia, Mich., which builds the Shelby Cobra GT, will supply the fiberglass components for the California Special.

Panel Session for College Students Is Slated Monday

John Martinelli, director educational activities for the National Association of Accountants, Monday will chair a panel discussion for college students on what they can expect during the first year of professional employment.

The panel discussion will be held in the Balboa Room at the Disneyland Hotel from 4 to 6 p.m.

Martinelli is accounting chairman, Accounting Department-Business Administration, at California

State College, Long Beach.

THE PANEL will consist of recent graduates from local colleges and universities representing national accounting firms, government agencies and local industry.

A similar session held recently at California State College, Long Beach, provided over a hundred students with a down-to-earth discussion which they said was informative, inspiring and rewarding.

'All About Money' Is Speaker Topic

Wendell Nobel, community relations director for Glendale Federal Savings, will speak to members of the Long Beach District Board of Realtors at their 7:15 a.m. breakfast meeting Tuesday at the Crown Cafeteria.

Program chairman Jerry Livoni said Noble's topic will be "All About Money." Rear Adm. Thomas S. Sargent, U.S. Coast Guard, will be the Realtors' guest.

Industry Conclave Set for Anaheim

Arthur Bornstein, memory expert, is the luncheon speaker at the Southern California Industry Conference to be held Saturday at the Grand Hotel, Anaheim. Title of his talk will be "Memory for Fun and Profit."

This is the fourth annual industry conference sponsored by the Orange County and Inland-Empire Chapters, American Institute of Industrial Engineers.

11311 Kensington Road, Los Alamitos, has been named to a newly created position in the natural resources division of Union Pacific Railroad. He will direct expanding activities in petroleum and mining exploration.

Forrest N. Shumway, president of Signal Oil and Gas Co., has been elected to the board of trustees of the University of Southern California.

Robert R. DeCanio, 9714 Raven Circle, Fountain Valley, has been named to the Los Angeles sales staff of Consolidated Freightways.

R. J. Higley of Pasadena has been appointed controller for National Airlines at the Miami general offices.

John Vahay, 7274 Santa Clara St., Buena Park, has been named assistant manager of Pacific Mutual Life's Los Angeles-Vance Agency.

Victor D. Iglesias, 1200 Pembroke St., Newport Beach, as been appointed manager of product support for Philco-Ford Corp. Acronutronic Division.

Promotion of three members of the corporate legal staff of Hunt Food and Industries Inc. was announced at the head offices in Fullerton, Milton L. Ray

was named general tax counsel and William K. Bachelder and Kenneth A. McGaw were promoted to associate general counsels. All three live in Fullerton.

Mrs. Sharon A. Hull, 233 Termino Ave., Long Beach, has been promoted to assistant secretary of the Long Beach trust office of United California Bank.

Don M. Muchmore, Long Beach, senior vice president, California Federal Savings, has been elected president of the board of trustees of California Museum Foundation, which supports the California Museum of Science and Industry in Exposition Park.

Four men from the Long Beach district office of National Life and Accident Insurance Co., will be guests of the company as sales leaders at a meeting in Palm Springs in April. They are W. H. Gates, M. D. Taylor, O. H. Duncan and C. J. Jabaay.

Richard A. Thomason, 13552 Olive St., Westminster, has been appointed project engineer of a new anchor designed at Aerojet's Ordnance Division. He is holder of a patent on the device which fires a projectile into the sea bottom to burrow the anchor.

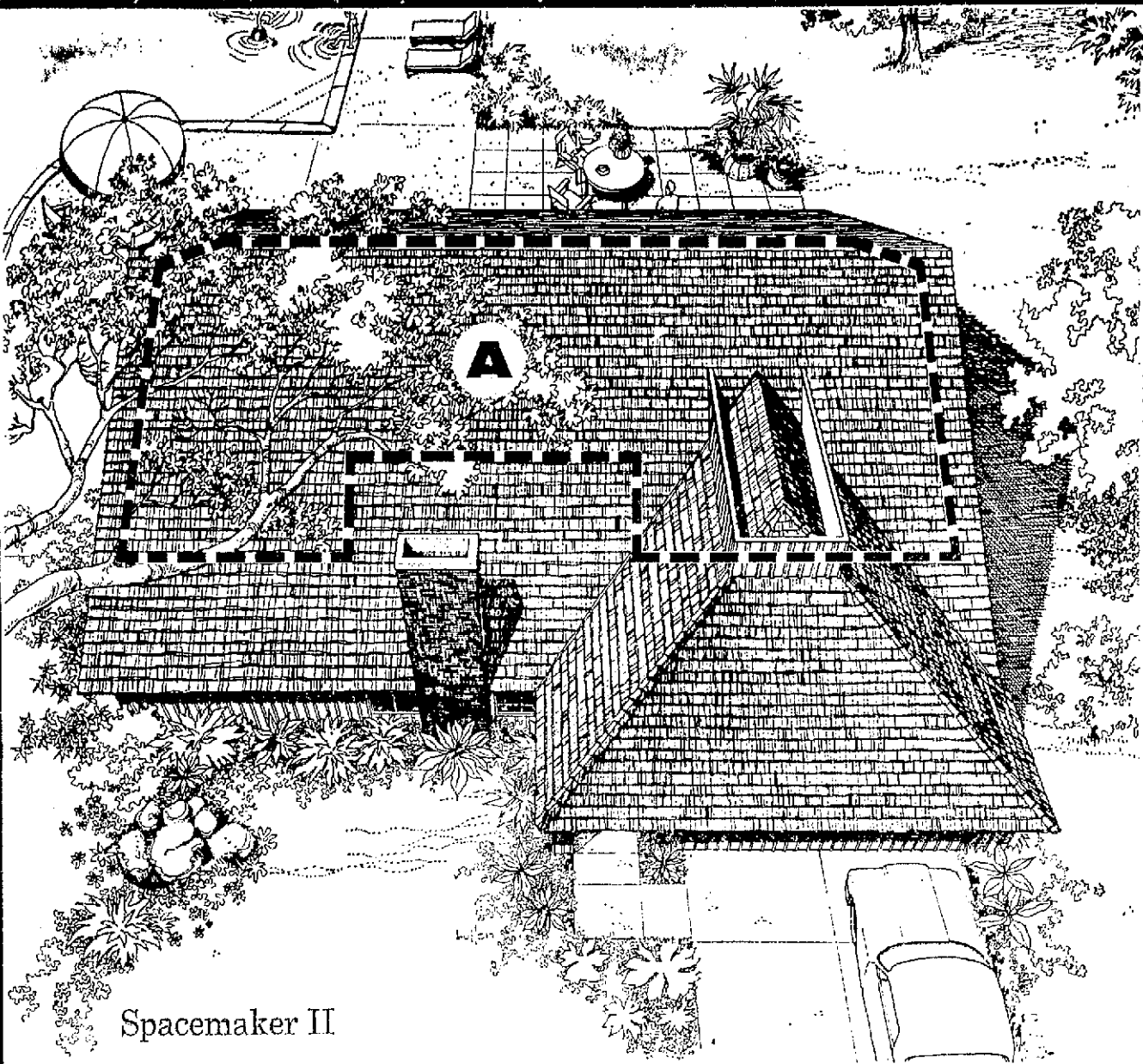

Spacemaker II

The Spacemaker.



You're looking at what we call our Spacemaker. We left a portion unfinished (don't worry, you can't see the unfinished portion from the inside or out).

This saves you about 2 or 3 thousand dollars on the initial cost. When you have more family or money (or both) you can finish all or part of the unfinished area.

For an idea of what can be done with it take scissors and cut out B and place over A. Now cut out C and place over B. Get it.

The Spacemakers come with up to 4 bedrooms and 3 baths. Not counting the Spacemaker area.

Spacemakers are too much house for the money.

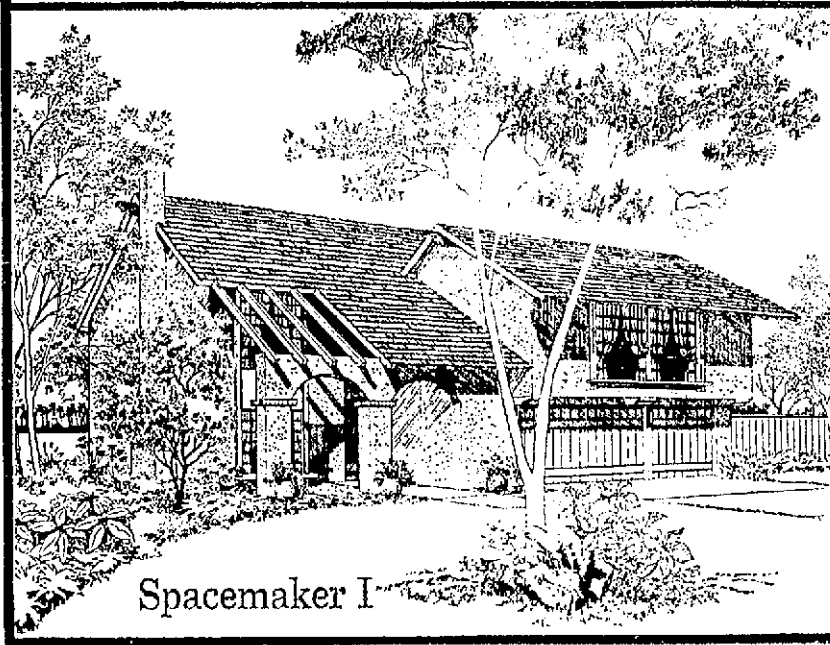
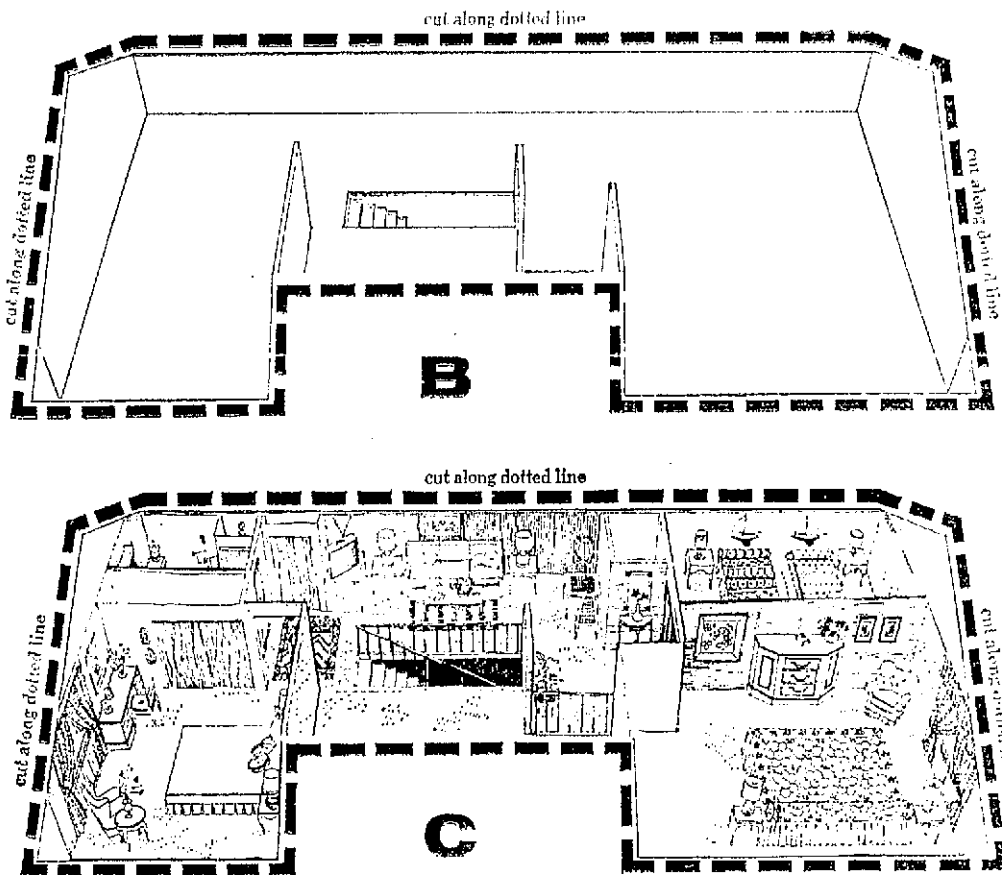

Spacemaker I

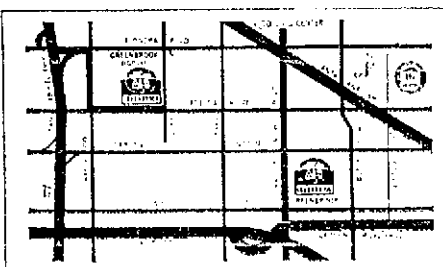

Greenbrook-Cypress. Take San Diego or Garden Grove Fwys. to Valley View, north to models. From Long Beach, Carson (Lincoln) to Valley View, south. From Santa Ana Fwy., Valley View south to models.

Greenbrook North-Cerritos. San Gabriel Fwy. to Alondra, East to Studebaker, so. to Artesia, east to models.

GREENBROOK

FROM \$26,950. Veterans no down payment. New Cold War Veterans terms. Easy FHA, Cal-Vet and conventional terms. On-the-spot trade-in for your present home.

Larwin Co. ©1966